

Part-turn reducers GP-22 – GP-3000

AKIM Gear technology – Swiss Made.

Part-turn reducers GP-22 – GP-3000.

Part-turn reducers are a further development based on the ACBAR system. All the gear ratios are integral and mathematically precise. Part-turn reducers are designed for rough use, for example for foundry application.

General informations.

- Developed based on the ACBAR system
- Reduction ratio up to 204 : 1 depending on design
- Driven by handwheel with double sided acting wrap spring brake
- Drive hollow shaft with involute toothing
- Output hollow shaft with keyway on request
- Mounting B5
- Grease lubrication
- Very robust design
- No oil fittings

Technical data.

Type	GP-22	GP-50	GP-160	GP-500	GP-3000
Reduction ratio	61	61	69	139	204
Output nominal torque [Nm]	220	500	1'600	5'000	30'000
Max admissible output torque [Nm]	860	1'650	4'800	15'000	60'000

Drawing with involute toothing.

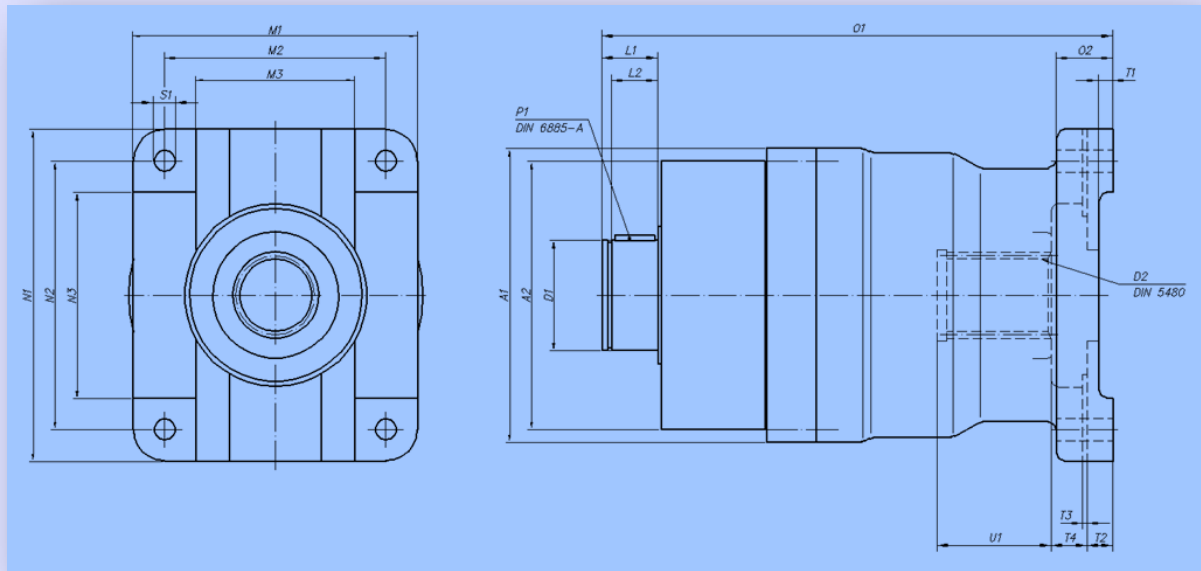

Dimensions.

Type	GP-22/1	GP-50/1	GP-160/1	GP-500/1	GP-3000/1
Values	Dimensions				
A1	186	255	320	410	500
A2	170	170	260	260	260
D1	70-h6	70-h6	105-h6	105-h6	105-h6
D2	N50x2x24x9H	N60x2.5x28x9H	N80x2.5x30x9H	N100x2.5x42x9H	N140x4x35x9H
L1	35	35	48	48	48
L2	29	29	39	39	39
M1	180	200	260	320	380
M2	140	140	190	240	270
M3	100.5	100.5	150.5	181	201
N1	210	250	310	460	510
N2	170	200	260	380	440
N3	130	150	200	300	340
O1	323	365	495	650	735
O2	36	45	50	70	100
P1	12x8x25	12x8x25	20x12x32	20x12x32	20x12x32
S1	14	18	22	26	26
T1	9	12	15	15	20
T2	16	20	26	41	60
T3	3	3	3	2	3
T4	23	25	18	7	8
U1	72	80	105	145	83

Drawing with keyway.

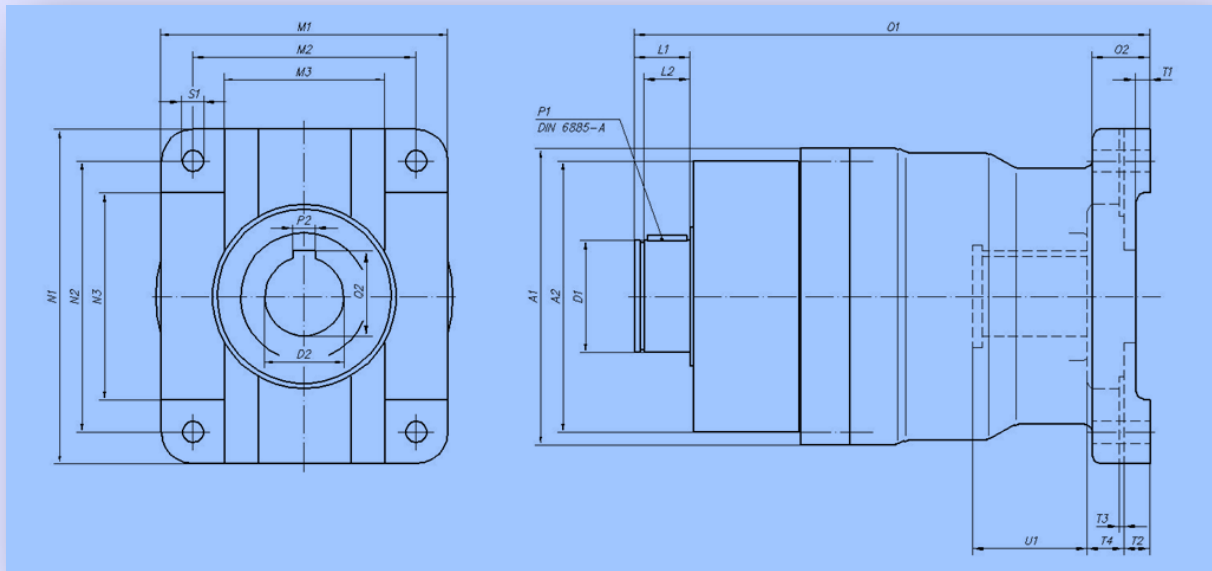

Dimensions.

Type	GP-22/2	GP-50/2	GP-160/2	GP-500/2	GP-3000/2
Values	Dimensions				
A1	186	255	320	410	500
A2	170	170	260	260	260
D1	70-h6	70-h6	105-h6	105-h6	105-h6
D2	50-H7	60-H7	80-H7	100-H7	140-H7
L1	35	35	48	48	48
L2	29	29	39	39	39
M1	180	200	260	320	380
M2	140	140	190	240	270
M3	100.5	100.5	150.5	181	201
N1	210	250	310	460	510
N2	170	200	260	380	440
N3	130	150	200	300	340
O1	323	365	495	650	735
O2	36	45	50	70	100
P1	12x8x25	12x8x25	20x12x32	20x12x32	20x12x32
P2	14-H9	18-H9	22-H9	28-H9	36-H9
Q2	53.8	64.4	85.4	106.4	148.4
S1	14	18	22	26	26
T1	9	12	15	15	20
T2	16	20	26	41	60
T3	3	3	3	2	3
T4	23	25	18	7	8
U1	72	80	105	145	83